



TU ESPACIO DE VIDA CONFORABLE

ENFRIADOR ECOLÓGICO

EVER

SISTEMA EVAPORATIVO AUTÓNOMO

Referencia: 1003652994

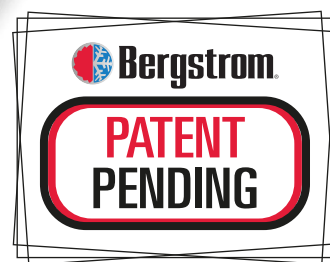

MANUAL DE USUARIO

ES

USER'S HANDBOOK

EN

MANUEL DE L'UTILISATEUR

FR

BENUTZERHANDBUCH

GE

MANUALE DELL'UTENTE

IT



Firstly, may we congratulate you on your decision to purchase the **EVER Ecological Cooler** from our Caravaning range. You are now the owner of a high-performance ecological cooler manufactured by **Bergstrom** for use in motorhomes and other recreational vehicles, regardless of whether the engine is running or not. **EVER** is the best choice when it comes to keeping pets cool and safe.

EVER is a technologically advanced solution that optimises performance and reduces energy consumption in your vehicle's auxiliary battery. These are the features that make it unique on the recreational vehicle climate control market, and will give you great satisfaction if used correctly.

The manual includes the latest technological advances in this range at the time of publication. However, continuous improvement means there may be minor differences.

All indications published in this manual are non-binding. In particular, **Bergstrom** reserves the right to make changes to the technical details, prices, colours, shapes, design, equipment, material and functions of the service without prior notice and without giving its reasons; it also reserves the right to adapt its equipment to local conditions in certain markets, and to end production of a given model without prior notice. **Bergstrom** shall be in no way liable for any issues around the availability of equipment, for differences between pictures or descriptions and the actual model, or for errors or omissions in this publication.

© 2024 Dirna Bergstrom SLU. Spain

All rights reserved

Any form of reproduction without the written permission of the copyright owner is strictly forbidden.

This document is valid for the following models: **CARAVANING range EVER**



ER-0022/1999



RA02-0027/2012
IATF: 0323311



GA-2021/0140



Dirna Bergstrom uses excellence assurance processes in accordance with international quality management standards ISO 9001, Automotive Quality IATF 16949, and Environmental Management ISO 14001 to ensure the highest quality of its products. Certified by IQNet Quality System.

Read this document carefully before using the product.

Keep this document for future reference.

All product manuals are available in digital version (PDF) at

<https://www.bergstromspain.com/>



All sales and warranty transactions are subject to the latest version of our general terms and conditions of sale, as published on our website

<https://www.bergstromspain.com/>

Advertencias sobre el manejo del producto:

- >> Only use **EVER** for the purposes envisaged by the manufacturer. Do not modify the equipment unless authorised by the manufacturer.
- >> The unit must not be started up if it is damaged or its power cable appears to be damaged or incomplete.
- >> **EVER** can only be used by children over 8 years of age and persons with reduced physical, sensory, or mental capabilities or lack of experience and knowledge whenever they are duly supervised or given appropriate training in using the equipment safely, and also understand the hazards involved.
- >> **EVER** is not a toy, so do not let children play with the equipment.
- >> **CAUTION:** Before starting up the unit, ensure that the main power connection cable and the battery charge test cable are connected properly.
- >> Do not insert your fingers or any objects through the fan vents.



Using the product correctly:

- >> **EVER** is a high-performance ecological roof cooler suitable for use in caravans and other recreational vehicles. It is not suitable for installation and operation in agricultural or construction machinery that is subject to intense vibrations.
- >> To ensure the unit works properly, it is best to keep the vehicle level, or, failing this, to place the front of the cooler at the highest point. If warning  9 appears on the screen, **AUTO** or **MANUAL** mode will reactivate once the vehicle is level.
- >> If you are unsure how to use **OPENAIR**, check this guide or contact your installer or **Bergstrom** directly.



TECHNICAL CHARACTERISTICS

EVER ECOLOGICAL COOLER	
Voltage	12 V
Electricity consumption when running	1,4 - 7,3 A
Airflow	Self-regulating / Adjustable
Number of fan speeds	8
Maximum airflow	420 m³/h
External unit dimensions (L x W x H)	860 x 787 x 197 mm
External unit weight	16 kg
Interior console dimensions (L x W x H)	520 x 520 x 65 mm
Interior console weight	2 kg
Assembly components weight	5 kg
Operation modes	AUTO - MANUAL - FAN
Control panel	Touch panel
Remote control	IR
Auto-off settings	YES (from 15 min to 9 h)
Ambient light LED	YES
Power cable	Included
Ideal vehicle length	Up to 7 m
Roof opening dimensions	400 x 400 mm
Roof thickness	From 30 mm to 60 mm

Dirna Bergstrom states that the **EVER** cooler meets the requirements of the following EC Directives and that the harmonised standards and technical specifications listed below have been adhered to:

- EC Directive 2006/42/EU
- EC Directive 2011/65/EU
- EC Directive 2014/30/EU

CONTROL PANEL OPERATION

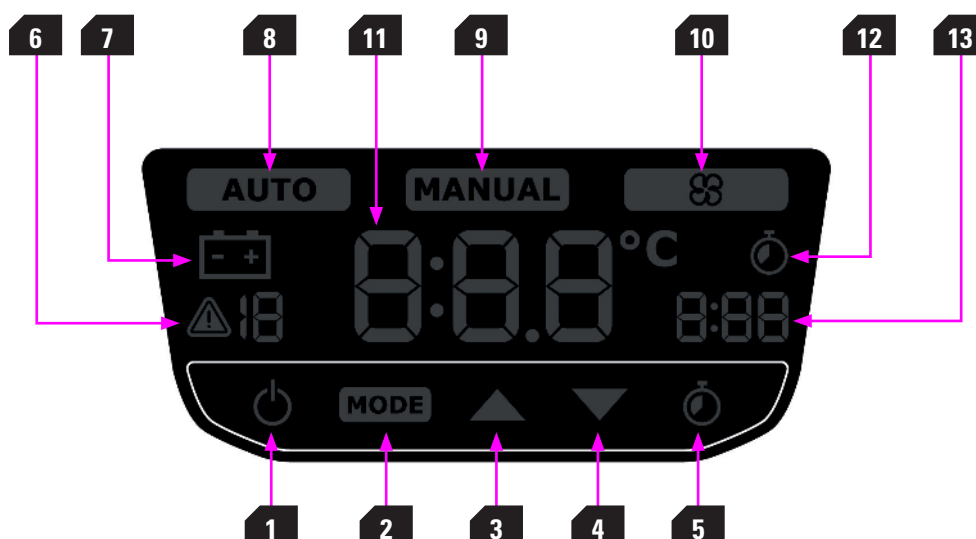

- 1 ON/OFF:** Cooler unit On/Off button. Pressing once turns the unit on and leaves it ready for operation. The unit goes off when pressed with the cooler on.

Pressing and holding the On/Off button turns the LED on at maximum brightness; holding it down gradually decreases brightness by approximately 20% every half second; and releasing the button will maintain the same brightness as the LED.

- 2 MODE:** Select the unit's operation mode from between AUTO, MANUAL and FAN.

Operation modes:

- **AUTO:** Automatic operation: Allows flow temperature to be selected between 18 and 27 °C (64.4 - 80.6 °F). The user can select unit operation from 8 different blower speeds. While the unit is running in automatic mode, the display will switch between showing blower speed and supply air temperature every 5 seconds.
- **MANUAL:** Manual operation: The user can select from 8 different blower speeds with the cooler operating at maximum capacity. The display will only show the selected blower speed while the unit is running in manual mode.
- **FAN:** Fan function: Allows blower speed to be selected from 8 speeds. In this operation mode, the cooler will only supply ambient temperature air.

- 3** Button to increase temperature selection by 0.5 °C in AUTO mode, time in AUTO-OFF SETTINGS, and blower speed in AUTO, MANUAL and FAN modes. In AUTO mode, a long press increases blower speed. Each press in AUTO-OFF SETTINGS mode increases auto-off time by 15 min.

- 4** Button to reduce temperature selection by 0.5 °C in AUTO mode, time in AUTO-OFF SETTINGS, and blower speed in AUTO, MANUAL and FAN modes. In AUTO mode, a long

press reduces blower speed. Each press in AUTO-OFF SETTINGS mode decreases auto-off time by 15 min.

5 **CLOCK:** Button to activate AUTO-OFF SETTINGS mode and confirm the selected auto-off time.

6 Incident warning LEDs during operation:

▲ : Humidity and temperature sensor error.

▲ : Water pump error.

▲ : Blower error.

▲ : Water supply error.

▲ : Humidity filter replacement alert.

▲ : Excessive unit slant.

▲ : Low battery warning.

7 Low battery level LED.

8 AUTO mode operation LED.

9 MANUAL mode operation LED.

10 FAN mode operation LED.

11 **Display:** Display showing temperature, blower speed or auto-off time, depending on the unit's operation mode. The digits will be blue while selecting, and then turn white after a few seconds once the required temperature has been reached, confirming the selection. Once a value is set, the display's brightness will decrease after 10 min of inactivity, turning off completely after 35 min of inactivity.

12 Auto-off mode operation LED.

13 Auto-off timer time left indicator.

REMOTE CONTROL



- 1 ON/OFF:** Unit On/Off button. Pressing once turns the unit on and leaves it ready for operation. The unit goes off when pressed with the cooler on.
- 2 MODE:** Select the unit's operation mode from between AUTO, MANUAL and FAN.
- 3 CLOCK:** Activate AUTO-OFF SETTINGS mode and confirm the selected auto-off time.
- 4** Button to turn on, off and change the different LED brightness levels.
- 5** Button to increase temperature selection by 0.5 °C in AUTO mode, time in AUTO-OFF SETTINGS, and blower speed in AUTO, MANUAL and FAN modes. In AUTO mode, a long press increases blower speed. Each press in AUTO-OFF SETTINGS mode increases auto-off time by 15 min.
- 6** Button to reduce temperature selection by 0.5 °C in AUTO mode, time in AUTO-OFF SETTINGS, and blower speed in AUTO, MANUAL and FAN modes. In AUTO mode, a long press reduces blower speed. Each press in AUTO-OFF SETTINGS mode decreases auto-off time by 15 min.

INITIAL UNIT CONFIGURATION



Caution: Before starting up the cooler for the first time, ensure that the main power connection cable and the battery charge test cable are connected properly.

The cooler will initially show its software version on the display when powered up for the first time.



After a few seconds, it will switch to initial settings mode, enabling the vehicle battery type connected to the unit to be selected from the control panel, either lead (Pb) or lithium (Li). Select the required option using the up or down buttons on the control panel or remote control, and confirm with the cooler's ON/OFF button.



To complete the settings, the user must select the temperature measurement scale for the cooler, in either degrees Celsius (°C) or Fahrenheit (°F). Select the required option using the up or down buttons on the control panel or remote control, and confirm with the cooler's ON/OFF button. After this last confirmation, the unit will switch to "Stand by" mode and remain ready to power up.

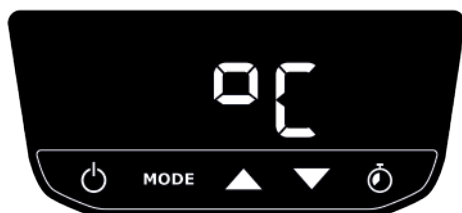

To reconfigure the temperature scale type, simply press the MODE and CLOCK buttons on the control panel at the same time for a few seconds with the unit turned off to return to the settings. This must be reset by fully disconnecting it from the power source in order to change battery type selection for the unit.

Note: This settings menu can also be used to remove warning  - Humidity filter replacement alert from the control panel.



ATTENTION: When starting up for the first time, use manual mode at 8th speed to achieve rapid wetting of the filter. Keep in mind that during this process there may be several actuations of the solenoid valve and the pump until a state of equilibrium is reached in the water tank of the cooler.

TURNING ON THE UNIT

The ON/OFF button on the control panel or remote control must be pressed in order to turn the **EVER** cooler on. The cooler will start up in automatic operation mode (AUTO) with the default parameters when turned on for the first time. From this moment on, the cooler will start up with the last settings selected by the user before shutting down.

SELECTING OPERATION MODES

To change the unit's operation mode with the unit running, press the MODE button on the control panel or remote control until the required option is reached between AUTO, MANUAL and FAN modes. The different options will light up in blue while selecting an operation mode; when the required option is reached, wait for a few seconds until it lights up in white, confirming the selection. Once an operation mode is set, the brightness of the display will decrease after 10 min of inactivity and will finally turn off completely after 35 min of inactivity.

AUTOMATIC OPERATION MODE - AUTO

Users can select the target supply temperature between 18 and 27 °C (64.4 - 77 °F) by opting for automatic operation mode (AUTO). The target temperature can be changed using the up and down buttons on the control panel and remote control. Blower speed can be adjusted by long presses of the up and down buttons on the control panel and the remote control. During AUTO mode operation, the display will alternately show blower speed and the selected target temperature every 5 seconds.

MANUAL OPERATION MODE

When selecting MANUAL operation mode, the user can choose between 8 different blower speeds with the cooler running at maximum capacity. The display will only show blower speed while the unit is running in MANUAL mode. Blower speed can be changed using the up and down buttons on the control panel and remote control.

FAN OPERATION MODE

Once FAN operation mode is selected, the user can select blower operating speed from between 8 different speeds. In this operation mode, the cooler will only supply ambient temperature air. Blower speed can be changed using the up and down buttons on the control panel and remote control. The display will only show blower speed while the unit is running in FAN mode.

AUTO-OFF SETTINGS

Activating the operating timer via the CLOCK button on the control panel or remote control allows the user to set the unit's operating time in 15-minute intervals (ranging from 15 minutes to 9 hours) using the up and down buttons, after which the cooler will shut down completely. The different time ranges will be lit up in blue when selecting, and the required time is then set by pressing the CLOCK button again. A selected time can be modified by editing it using the CLOCK button and the up and down buttons on the panel or remote control.

REPLACING THE REMOTE-CONTROL BATTERY



The remote control uses a 3V CR2025 battery.



EU Directive 2012/19/EU

Waste of electrical and electronic equipment (WEEE)

Nota sobre la protección medioambiental:

Los aparatos eléctricos y electrónicos, así como las baterías, no se deben evacuar en la basura doméstica. El usuario está legalmente obligado a llevar los aparatos eléctricos y electrónicos, así como pilas y pilas recargables, al final de su vida útil a los puntos de recogida comunales o a devolverlos al lugar donde los adquirió. Los detalles quedaran definidos por la ley de cada país. El símbolo en el producto, en las instrucciones de uso o en el embalaje hace referencia a ello.

GENERAL RECOMMENDATIONS

- >> The humidity filter (1) and the water filter assembly (2) must be replaced when the cooler's display shows warning nº 4 (every 2 years or earlier if environmental circumstances so require).
To clear warning nº 4 from the control panel, simply access the settings menu by pressing the MODE and CLOCK buttons on the control panel for a few seconds at the same time with the unit powered off.
- >> Emptying the water from the circuit is recommended in winter, in order to avoid damage from frost.
- >> In winter, it will also be necessary to install the protective covers (A and B) to prevent outside air from entering the vehicle.
- >> If the cooler is to be cleaned with a pressure hose, the unit's air intakes must have the protective covers in place (A and B). These parts must be removed when the cooler is put back into operation.

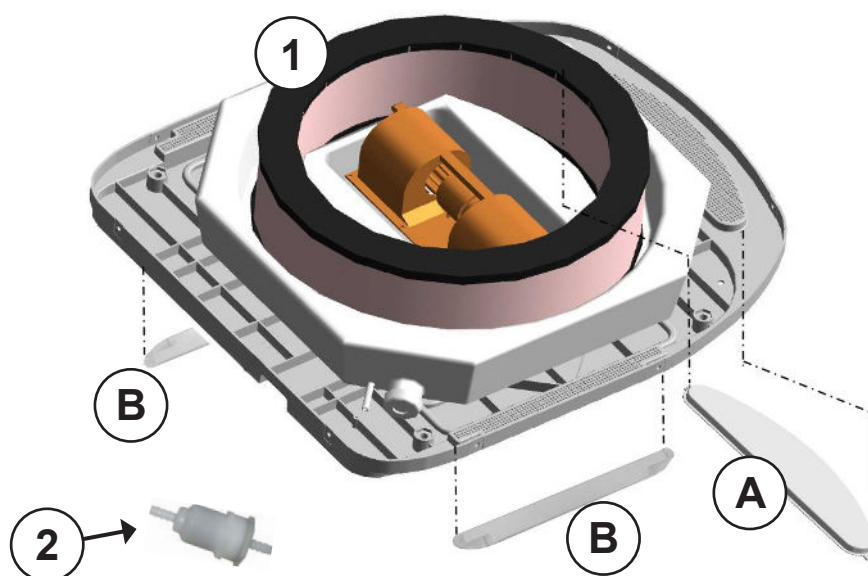



Assembling the winter protection covers

It is recommended to cover the cooler's front and side air intake grilles with the provided protective covers when the unit will not be in use for extended periods, especially during winter. These protection covers are marked with the word "WINTER" on the back.

Front protection cover (Photo A):

Used to cover the cooler's front air input, as shown in the photo.

Adjust the protection cover by fastening it at both ends; first one and then the other, inserting the tabs in the housing holes in the base of the unit.

Side protection covers (one on each side; Photo B)

Used to cover the cooler's 2 side grilles, as shown in the photo.

The covers will be adjusted by fastening them at both ends; first one and then the other, inserting the tabs in the housings in the sides of the unit's base.

Disassembling the winter protection covers

To remove the protective covers, release each fastening tab from the housings in the cooler's base.



IMPORTANT

The **EVER**-ecological cooler works by taking air from outside the vehicle. This air must not remain inside, as this would lead to excess humidity. All current vehicles are equipped with air renewal grilles; if they are not fitted, the installer must install them to ensure ventilation in the vehicle.

The user should also regularly check that the fan grilles are not blocked.

The user must also regularly check (at least every 6 months) the condition of the vehicle connection cables, especially the seal tight connectors.



CAUTION: Failure to comply with these instructions may result in injury to persons, damage to components, or equipment malfunction.



CAUTION: EVER should only use potable water for operation.

The **EVER**-ecological cooler and system must be cleaned and disinfected at least once a year, as well as when commissioned, after being shut down for more than one month, or after a repair or modification affecting the system the water flows through. It must be cleaned and disinfected whenever dirt, incrustations or sediments are identified.

The removable parts must be thoroughly cleaned and disinfected by immersing them with a suitable biocide product and then rinsing with plenty of cold water. Any fixed or difficult-to-dismantle elements should be covered with a clean cloth soaked in disinfectant for the required time (depending on the biocide used), and then rinsed thoroughly with water.

Accessing and disassembling the water tank:

- Take down the unit's outer cover by removing the (8) fastening screws.
- Disconnect the water input pipe to the humidity filter.
- Remove the humidity filter.
- Disconnect the cable from the (2) level probes at the top of the water tank.
- Disconnect all water tank pipes:
 - o Main input to the tank.
 - o Pump outlet.
- Disconnect the pipe that connects the water tank to the filter.
- Remove the water tank.

Assembly is carried out in reverse order to disassembly.

Tank cleaning and disinfection procedure:

- Thoroughly clean the surfaces, removing any encrustations or adhered substances. Rinse with water.
- Disinfect with a suitable biocide product.
- Neutralise the biocide by rinsing the tank with plenty of water.
- Fill the tank with potable water and restore normal conditions of use.

Dirna Bergstrom is not liable for any damage caused by using harmful or unauthorised products in the water circulation system.

The user is solely responsible for hygienic and sanitary use and maintenance of the product, in order to ensure its proper operation and avoid any health issues.

NOTAS

[illegible]

[illegible]



TU ESPACIO DE VIDA CONFORTABLE

Madrid, España

T. + 34 - 918-775-840

E. ventas@dirna.bergstrominc.com

W. www.bergstromspain.com

