

ENFRIADOR ECOLÓGICO

EVER

 SISTEMA EVAPORATIVO AUTÓNOMO

Referencia: 1003796878

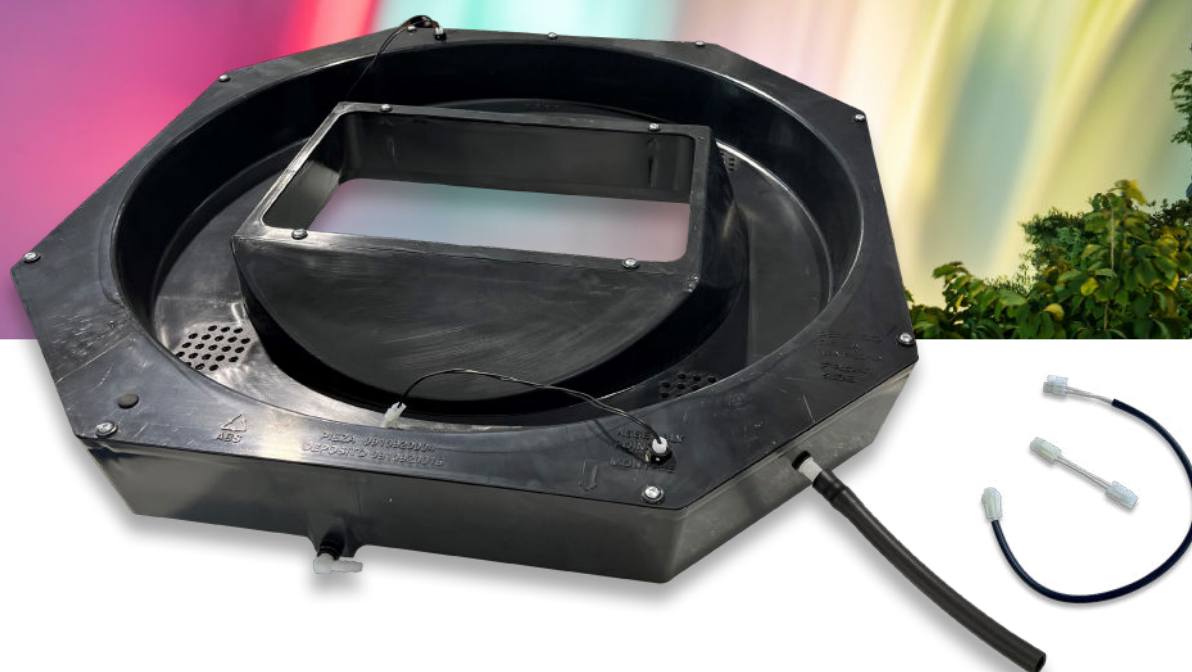

Gama Caravanning

SUSTITUCIÓN DEPÓSITO DE AGUA / INSTRUCCIONES DE MONTAJE

ES

REPLACING THE WATER TANK / MOUNTING INSTRUCTIONS

EN

REPLACEMENT RÉSERVOIR À EAU / INSTRUCTIONS DE MONTAGE

FR

AUSTAUSCH WASSERTANK / MONTAGEANWEISUNGEN

GE

SOSTITUZIONE SERBATOIO D'ACQUA / ISTRUZIONI DI MONTAGGIO

IT

1

Desconectar el cable de alimentación del enfriador situado en la parte trasera de la unidad del cableado de batería.

**2**

Desmontar la tapa exterior del enfriador retirando los (8) tornillos de fijación.

**3**

Desmontar el tubo de agua del filtro de humedad.

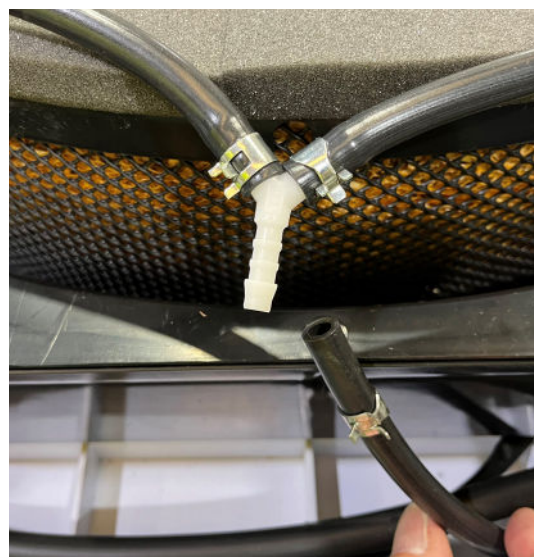

4 Retirar el filtro de humedad del enfriador.

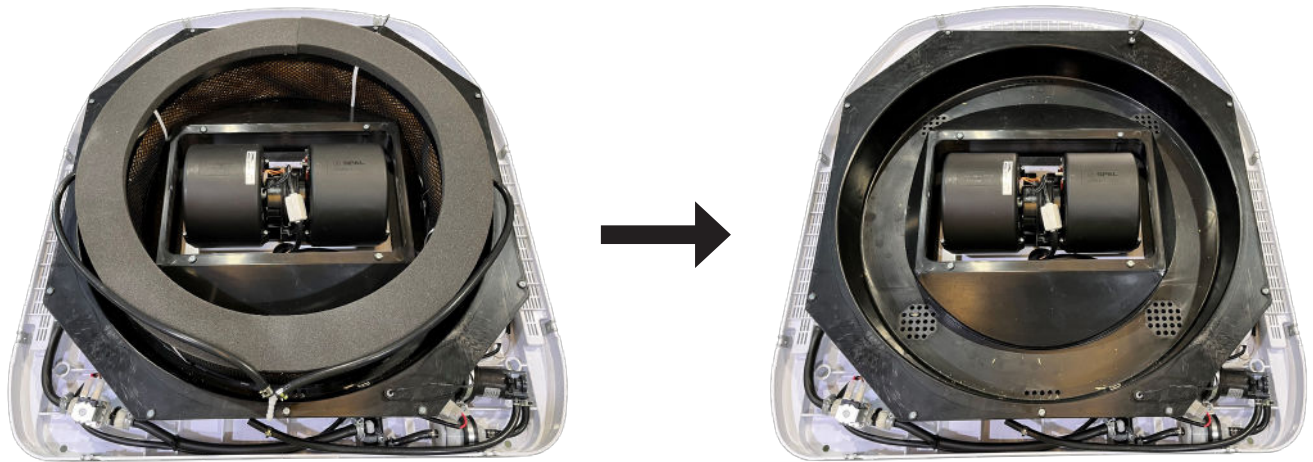

5 Desconectar los cableados eléctricos de los sensores de nivel del depósito de agua.

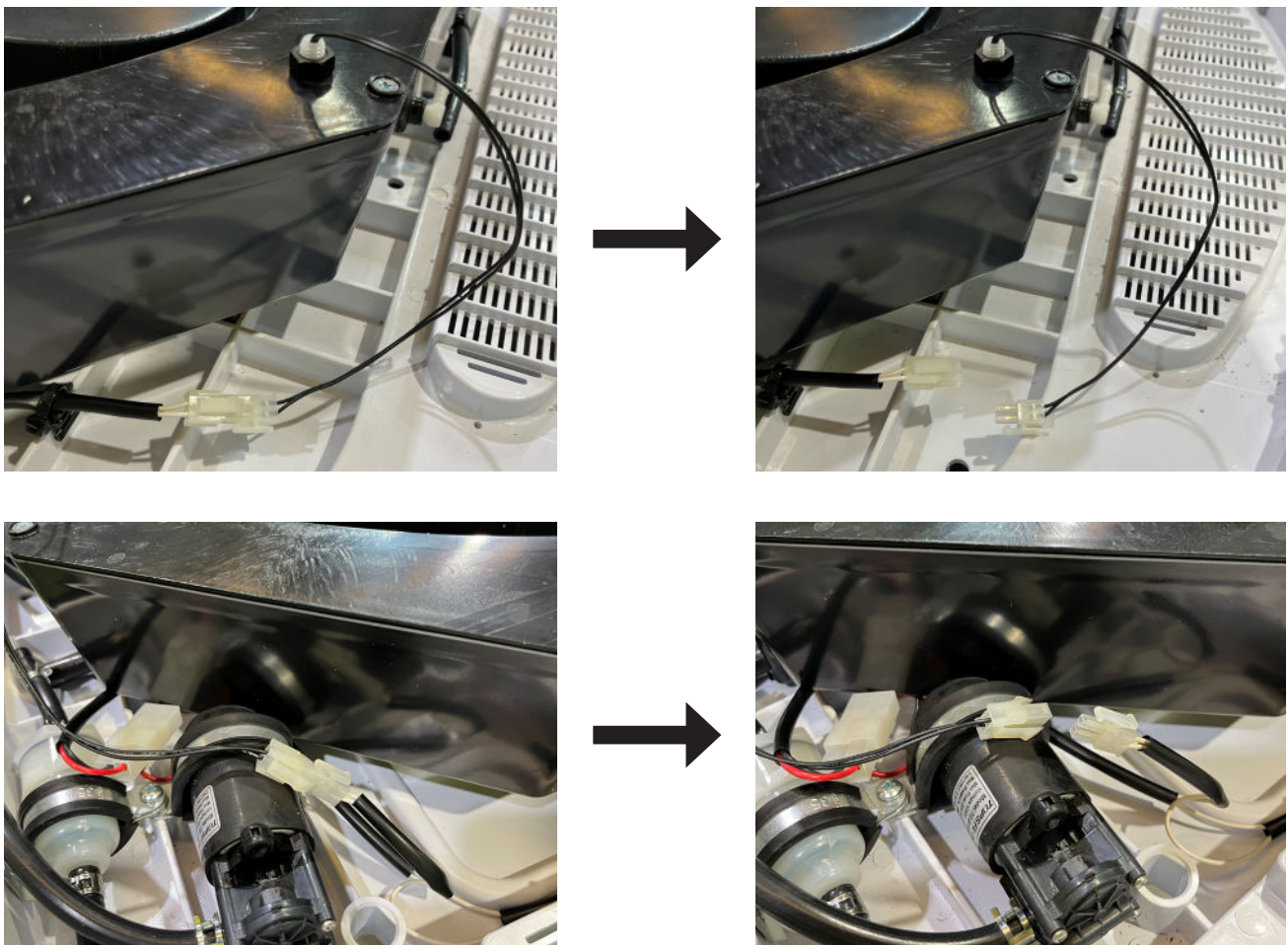

6 Desmontar los tubos de agua del depósito.

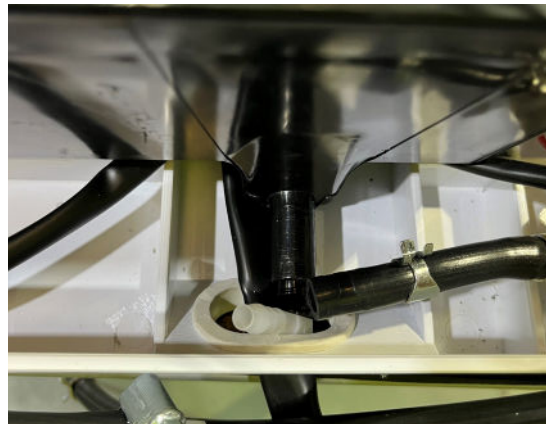
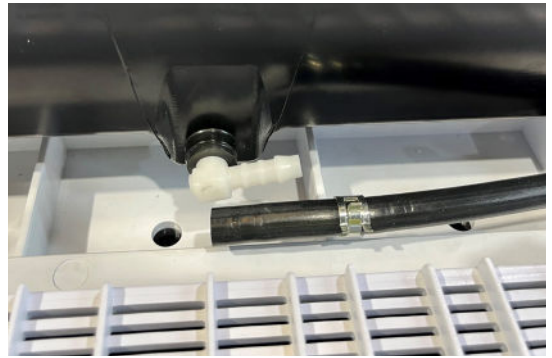
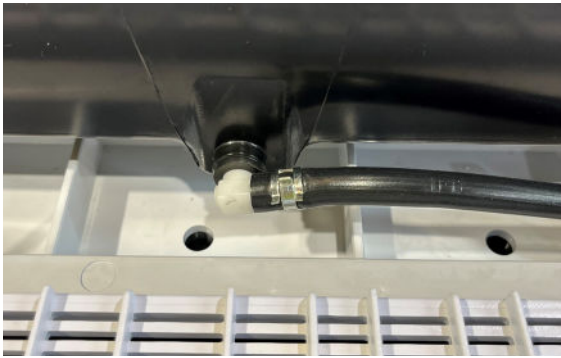

7 Retirar el depósito de agua del enfriador teniendo la precaución de no verter agua sobre la base de la unidad.



8 Colocar el depósito de recambio sobre la base del enfriador situando los tubos de los rebosaderos del depósito en los orificios correspondientes de la base.



9 Montar los tubos de agua en el depósito asegurándose de la correcta fijación de los tubos.

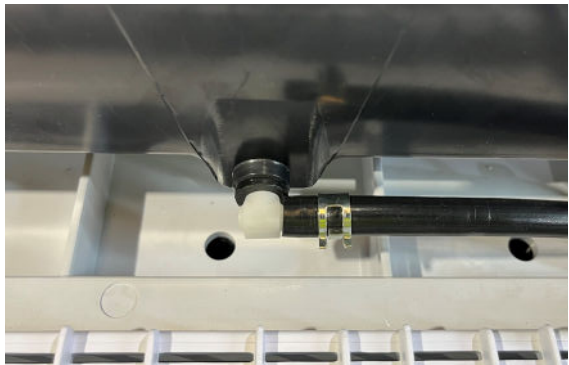

10 Volver a montar el filtro de humedad.



11

Conectar el tubo de agua del filtro de humedad.

**12**

Conectar cableado del sensor de nivel trasero del depósito al cableado de alimentación corto (suministrado en el recambio), y este, al cableado de alimentación componentes del enfriador.

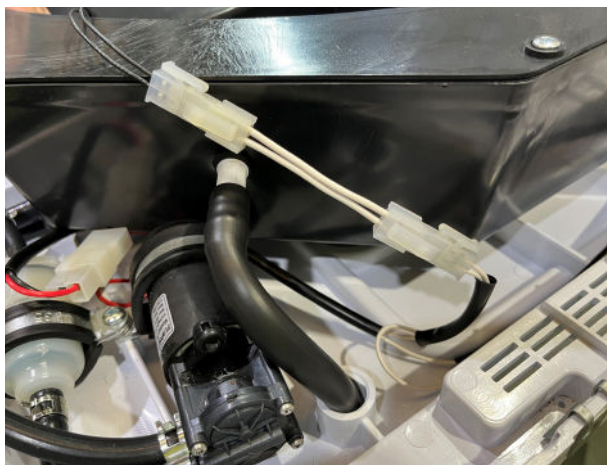
**13**

Conectar cableado del sensor de nivel delantero del depósito al cableado de alimentación largo (suministrado en el recambio), y este, al cableado de alimentación componentes del enfriador.

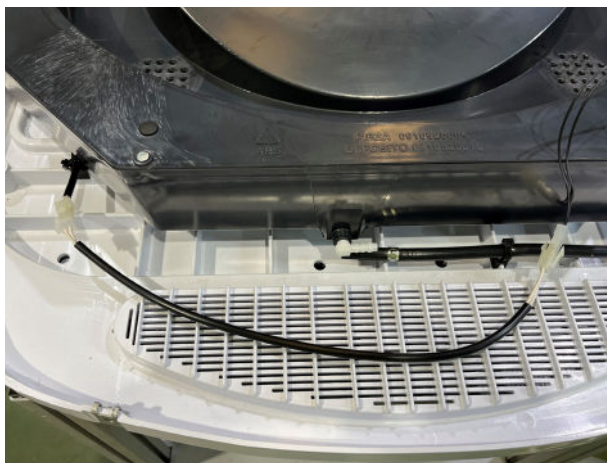

14 Montar la tapa exterior del enfriador con los (8) tornillos de fijación.



15 Conectar el cable de alimentación del enfriador al cableado de batería.

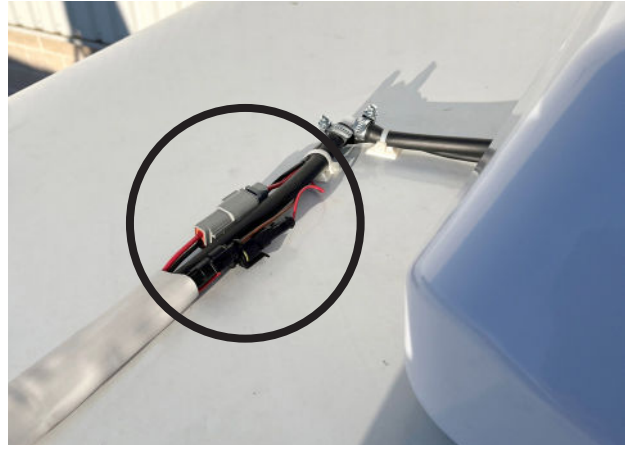

Listado de recambios



Id.	Ctd.	Referencia	Descripción
1	1	1003651563	Conjunto depósito
2	1	1003797276	Cableado extensión sensor de nivel

1 Disconnect the cooler's power cable at the rear of the unit from the battery's cable.



2 Take down the cooler's outer cover by removing the (8) fixing screws.



3 Remove the water pipe from the humidity filter.

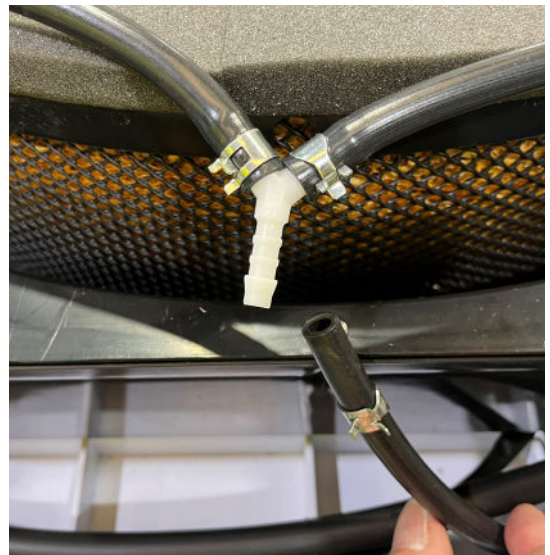

4 Remove the humidity filter from the cooler.

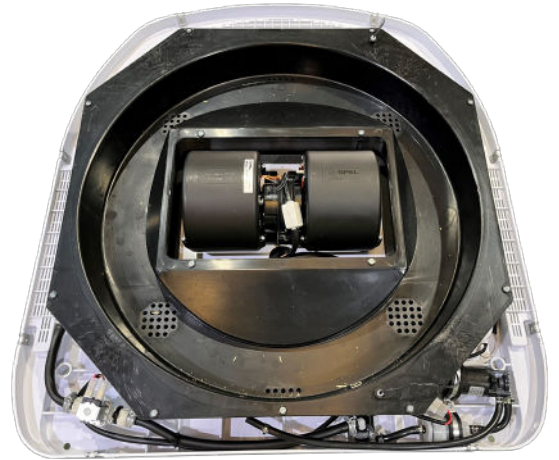
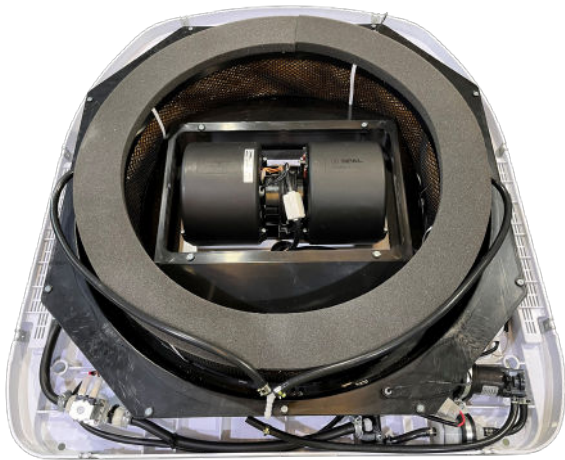

5 Disconnect the electrical cables from the water tank level sensors.

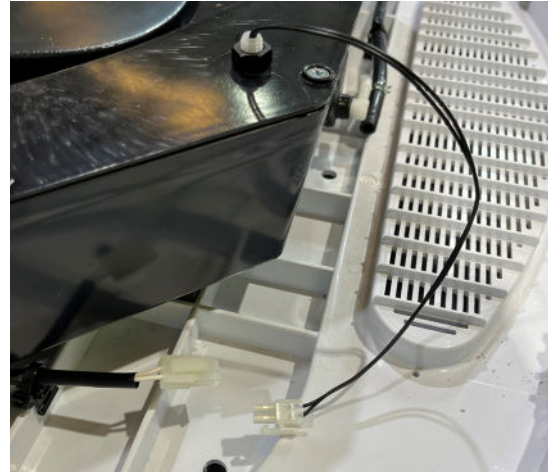
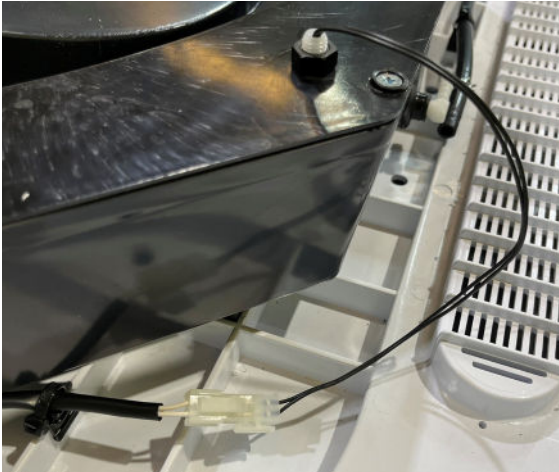

6 Disconnect the water pipes from the tank.

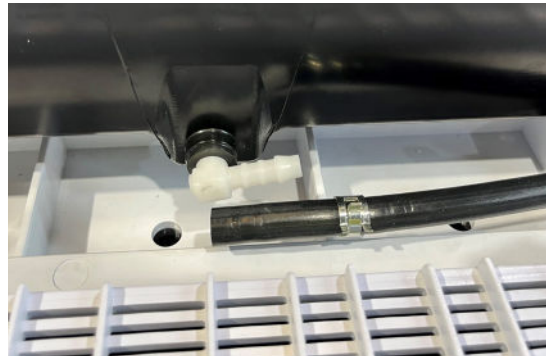
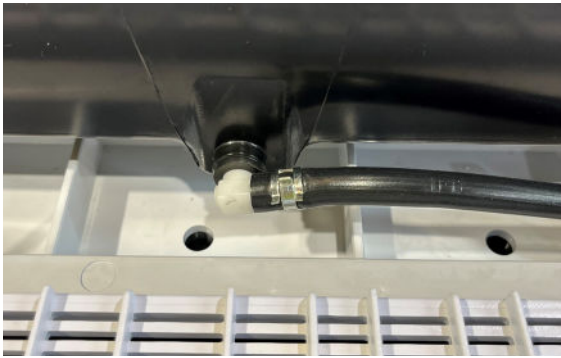

7 Remove the water tank from the cooler, taking care not to spill water on the base of the unit.



8 Place the replacement tank on the base of the cooler, positioning the tank's overflow pipes in the holes in the base.



9 Connect the water pipes to the tank, ensuring they are properly secured.

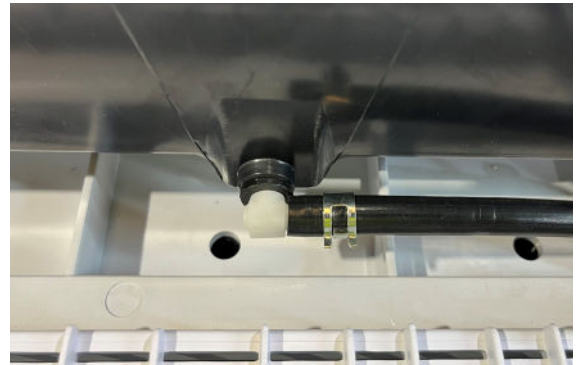

10 Reinstall the humidity filter.

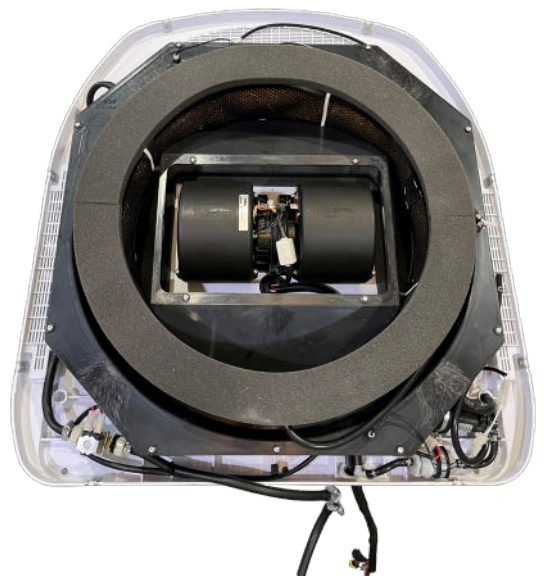

11

Connect the humidity filter's water pipe.

**12**

Connect the tank's rear level sensor cable to the short power cable components (supplied with the spare part), and this to the cooler's power cable.

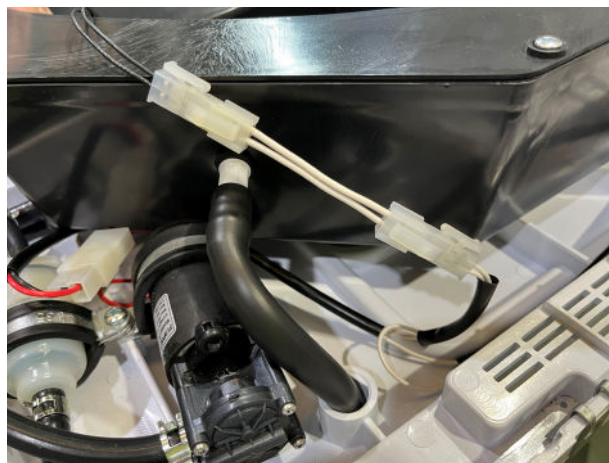
**13**

Connect the tank's front level sensor cable to the long power cable components (supplied with the spare part), and this to the cooler's power cable.

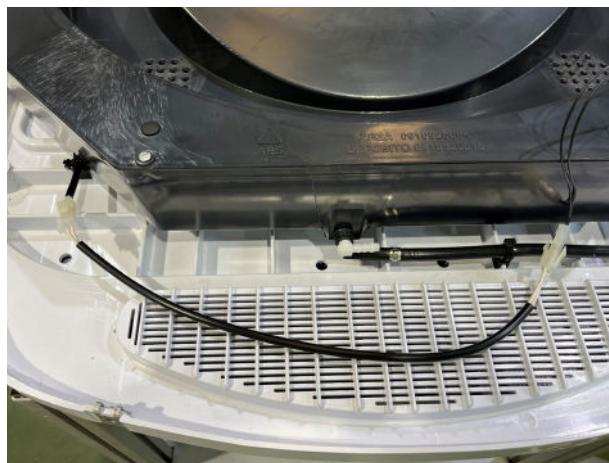

14 Mount the cooler's outer cover with the (8) fixing screws.



15 Connect the cooler's power cable to the battery cable.

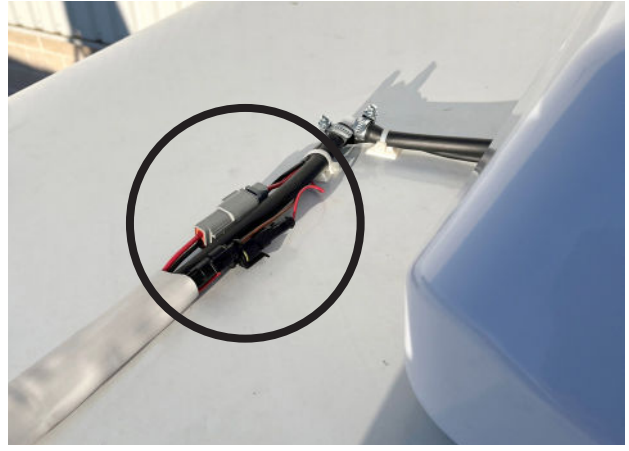

Parts list



Id.	Qty.	Code n°	Spare Parts
1	1	1003651563	Tank unit
2	1	1003797276	Level sensor extension cable

- 1** Débrancher le câble d'alimentation du refroidisseur situé à l'arrière de l'unité de câblage de la batterie.



- 2** Démonter le couvercle extérieur du refroidisseur en retirant les (8) vis de fixation.



- 3** Démonter le tuyau d'eau du filtre d'humidité.

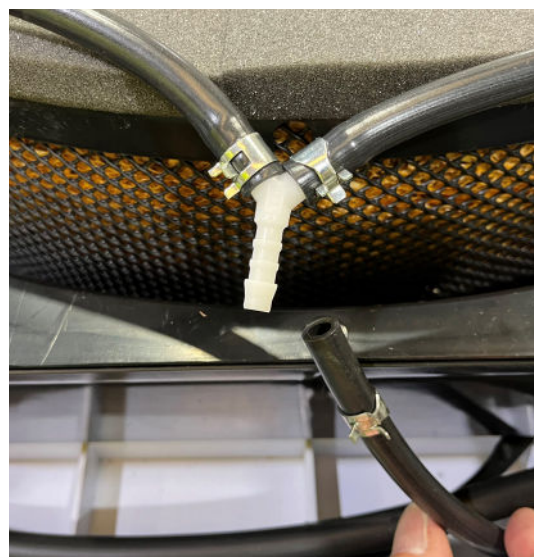

4 Retirer le filtre d'humidité du refroidisseur.

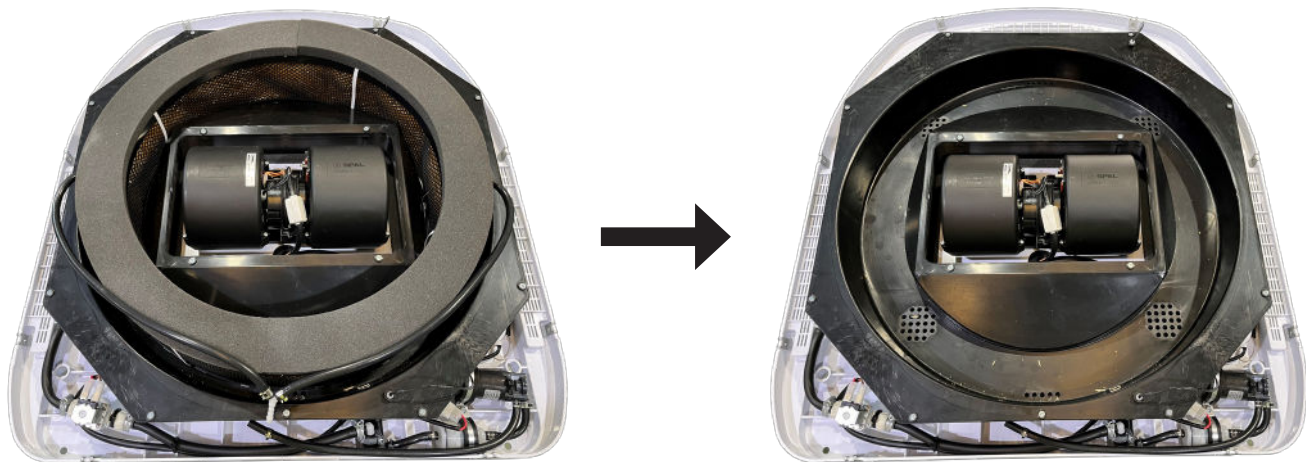

5 Débranchez les câblages électriques des capteurs de niveau du réservoir d'eau.

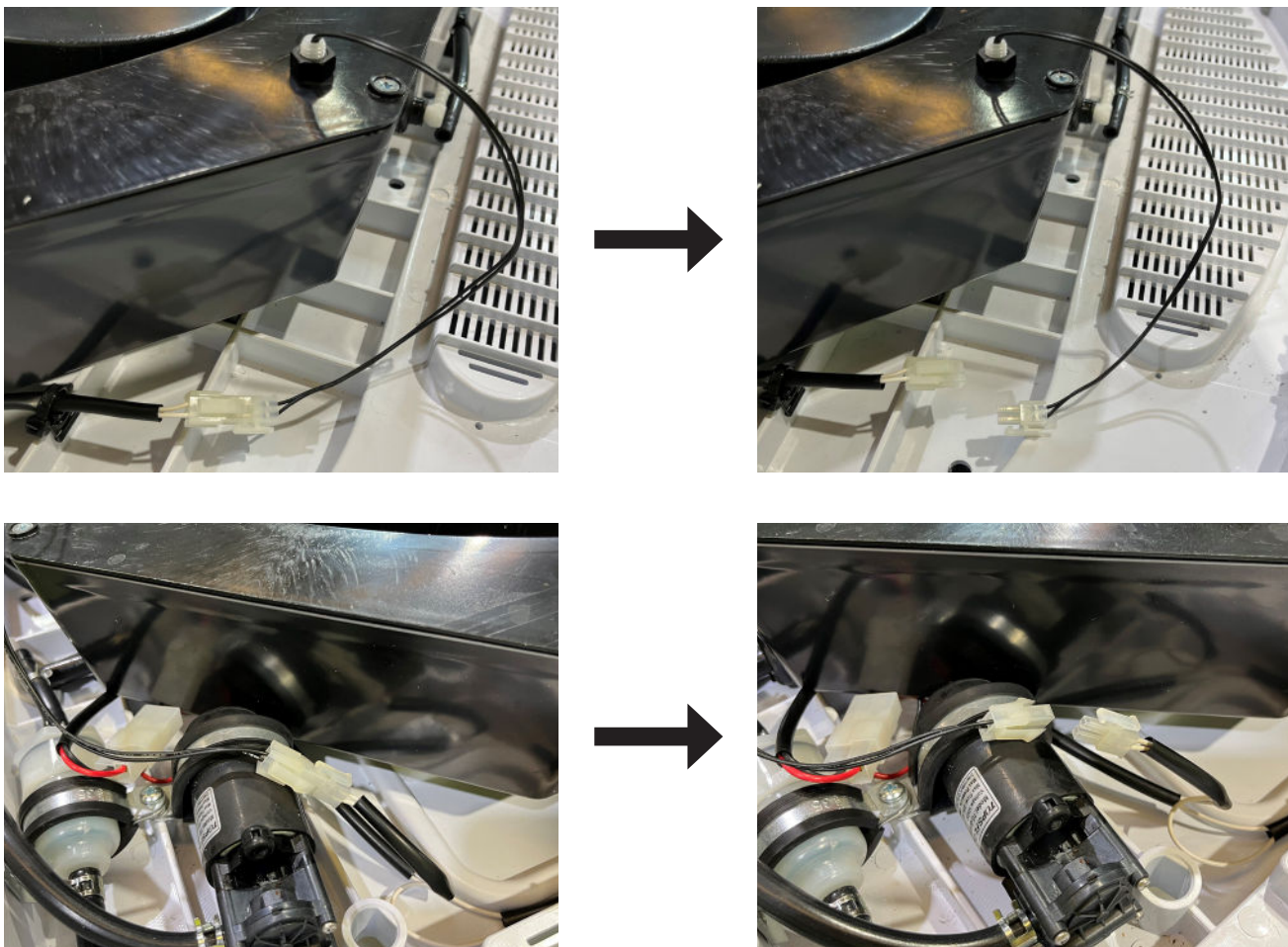

6 Démontez les tuyaux d'eau du réservoir.

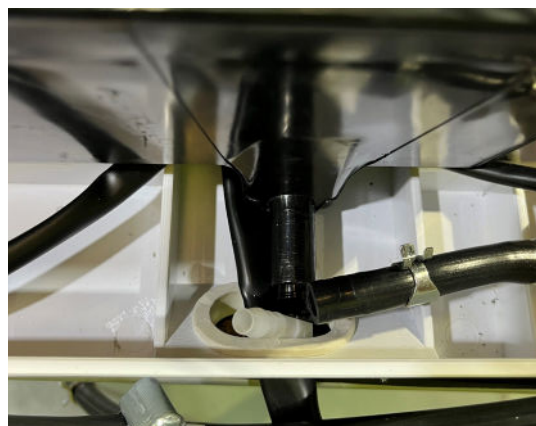
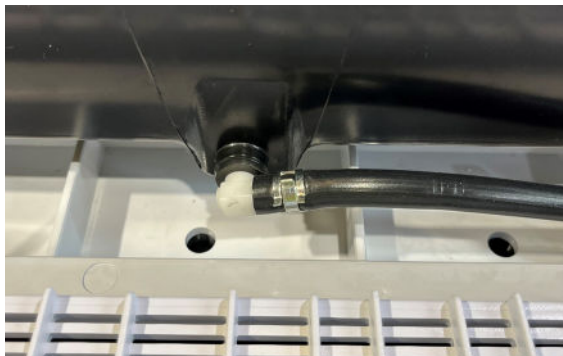

7 Retirez le réservoir d'eau du refroidisseur en faisant attention à ne pas verser d'eau sur la base de l'unité.



8

Placer le réservoir de recharge sur la base du refroidisseur en situant les tuyaux des trop-pleins du réservoir dans les orifices correspondants de la base.



9

Monter les tuyaux d'eau sur le réservoir en vous assurant qu'ils soient bien fixés.

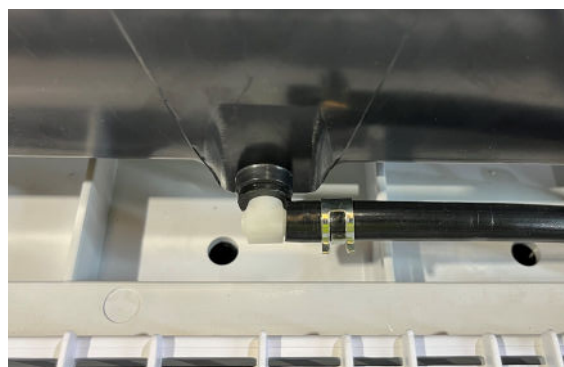

10

Remonter le filtre d'humidité.

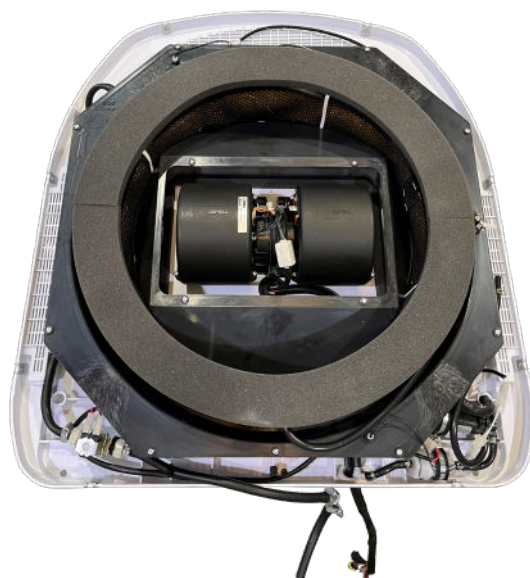

11

Raccorder le tuyau d'eau du filtre d'humidité.

**12**

Raccorder le câblage du capteur de niveau arrière du réservoir à celui d'alimentation court (fourni avec la pièce de rechange), et celui-ci au câblage d'alimentation des composants du refroidisseur.

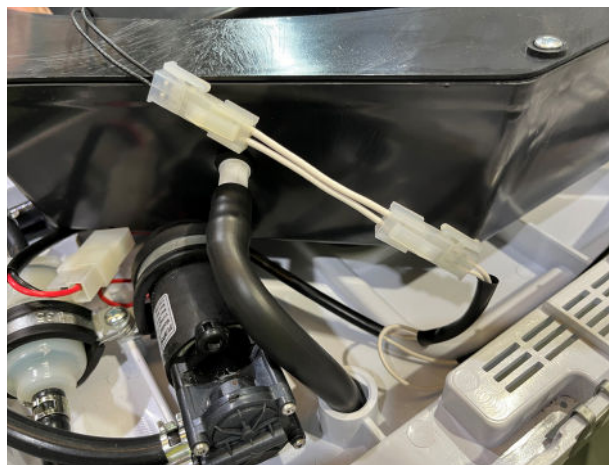
**13**

Raccorder le câblage du capteur de niveau avant du réservoir à celui d'alimentation long (fourni avec la pièce de rechange), et celui-ci au câblage d'alimentation des composants du refroidisseur.

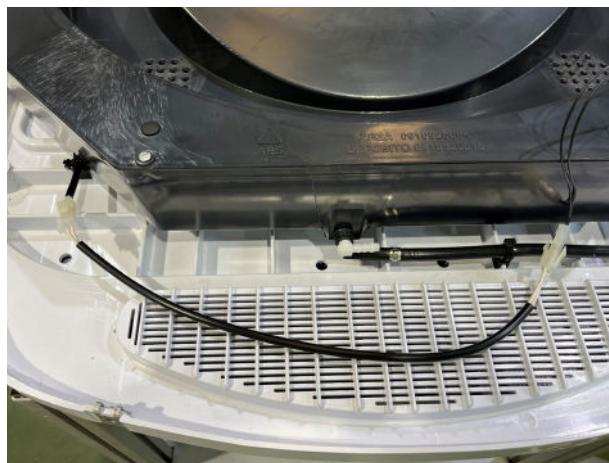

14

Monter le couvercle extérieur du refroidisseur à l'aide des (8) vis de fixation.



15

Brancher le câble d'alimentation du refroidisseur au câblage de la batterie.



Liste des pièces de rechange



Id.	Qté.	Référence	Description
1	1	1003651563	Ensemble de réservoir
2	1	1003797276	Rallonge du capteur de niveau

1

Das an der Rückseite des Kühlgeräts befindliche Stromkabel von der Batterieverkabelung trennen.

**2**

Die äußere Abdeckung des Kühlgeräts durch Abschrauben der (8) Befestigungsschrauben ausbauen.

**3**

Wasserschlauch vom Feuchtigkeitsfilter trennen.

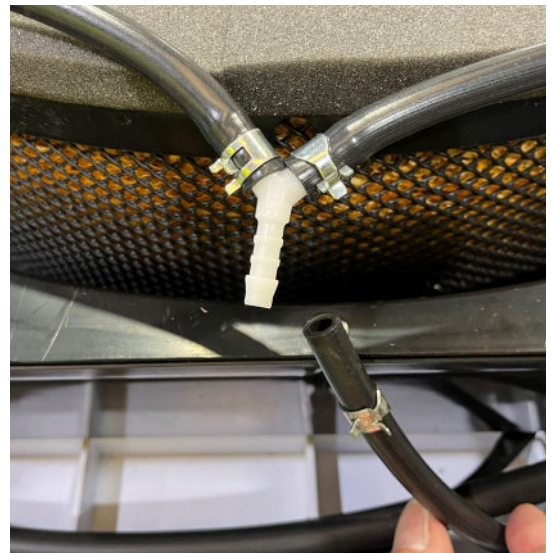

4 Feuchtigkeitsfilter aus dem Kühlgerät nehmen.

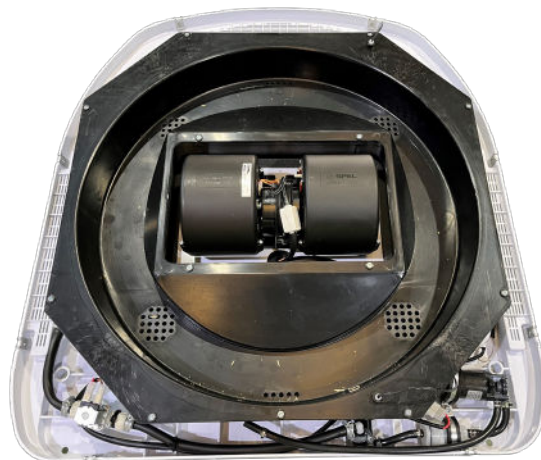
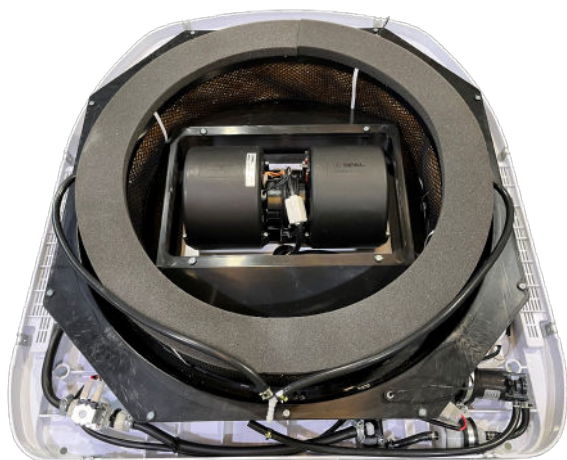

5 Stromkabel der Füllstandssensoren des Wassertanks trennen.

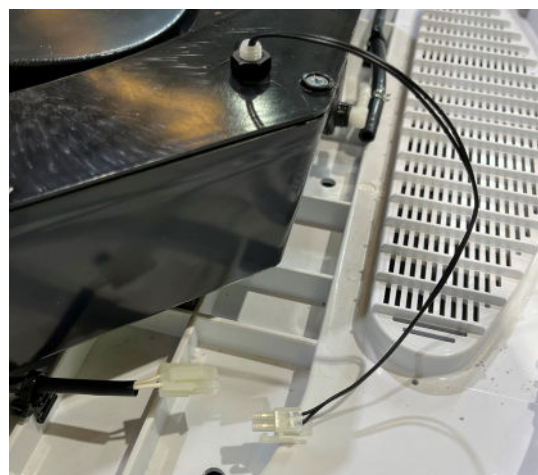
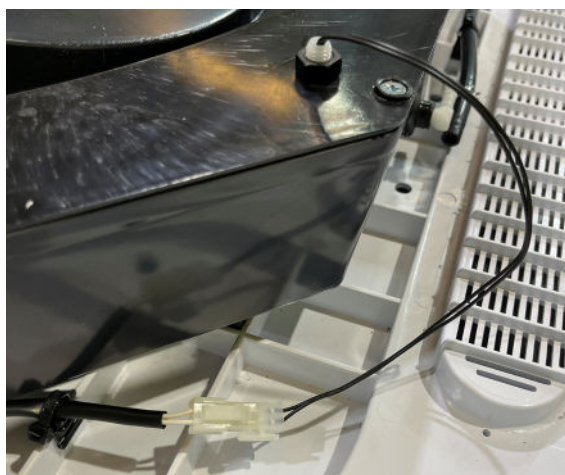

6 Wasserschläuche vom Tank nehmen.

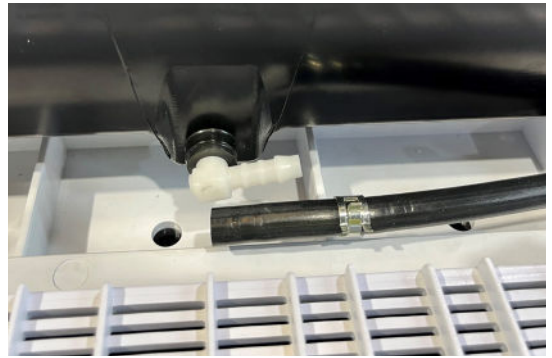
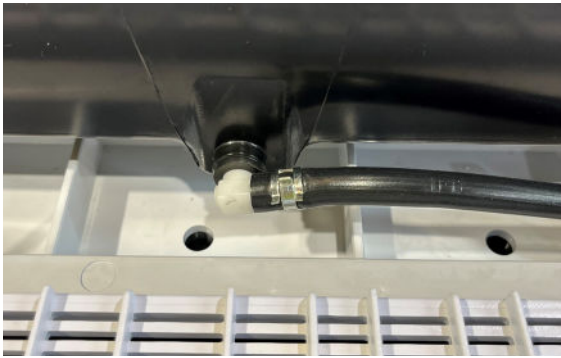

7 Wassertank aus dem Kühlgerät nehmen und dabei darauf achten, dass kein Wasser auf den Gerätesockel tropft.



8 Den neuen Tank auf dem Sockel des Kühlgeräts platzieren und die Schläuche der Überlaufstutzen an den entsprechenden Öffnungen des Sockels anbringen.



9 Die Wasserschläuche ordnungsgemäß am Tank anbringen.

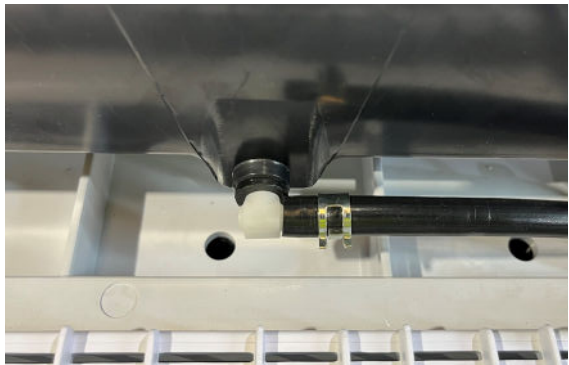
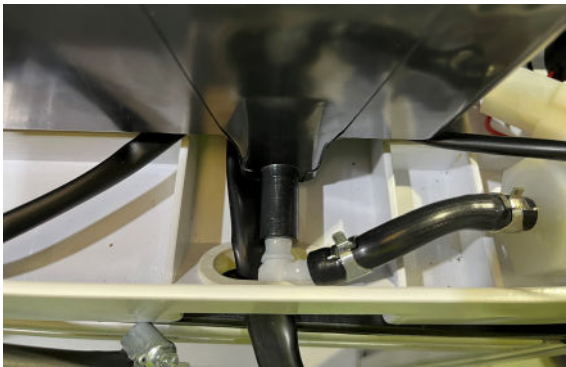

10 Feuchtigkeitsfilter wieder einsetzen.



11

Wasserschlauch des Feuchtigkeitsfilters anschließen.

**12**

Die Kabel des hinteren Füllstandssensors mit den kurzen (im Lieferumfang enthaltenen) Stromkabeln verbinden und diese mit den Stromkabeln der Kühlgerätekomponenten verbinden.

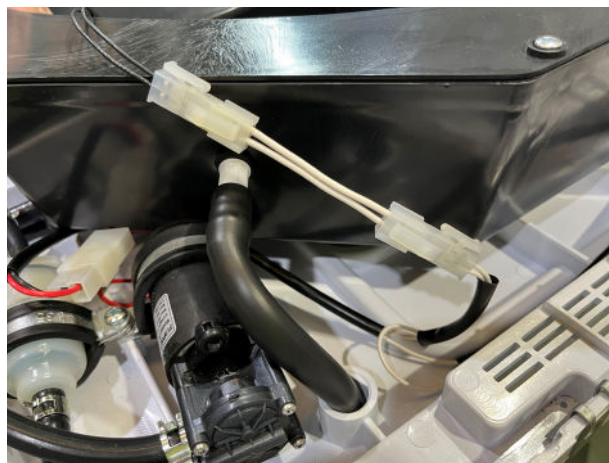
**13**

Die Kabel des vorderen Füllstandssensors mit den langen (im Lieferumfang enthaltenen) Stromkabeln verbinden und diese mit den Stromkabeln der Kühlgerätekomponenten verbinden.

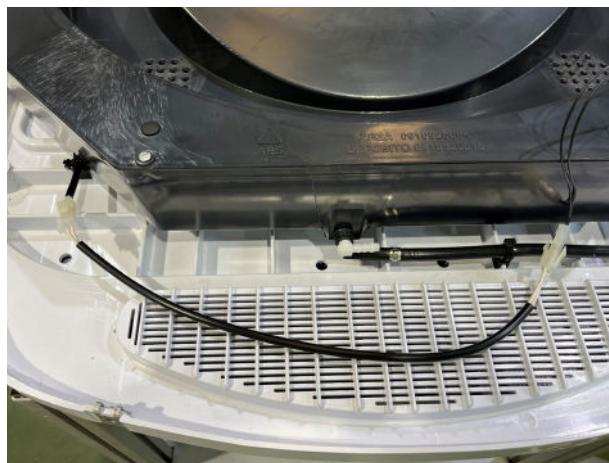

14

Die äußere Abdeckung des Kühlgeräts durch Anschrauben der (8) Befestigungsschrauben einbauen.



15

Die Stromkabel des Kühlgeräts mit den Batteriekabeln verbinden.



Ersatzteilliste



Nr	Stckzahl	Art. Nr.	Beschreibung
1	1	1003651563	Wassertank
2	1	1003797276	Verlängerungskabel Füllstandssensor

1

Scollegare il cavo di alimentazione del raffreddatore che si trova nella parte posteriore dell'unità del cablaggio della batteria.

**2**

Smontare il coperchio esterno del raffreddatore togliendo le (8) viti di fissaggio.

**3**

Smontare il tubo dell'acqua dal filtro dell'umidità.

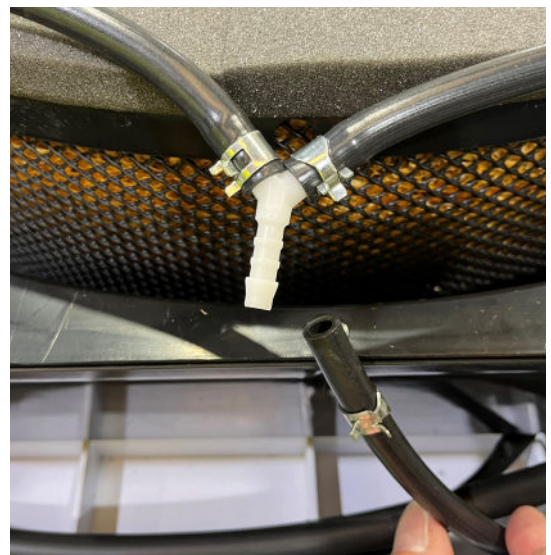

4 Togliere il filtro dell'umidità dal raffreddatore.

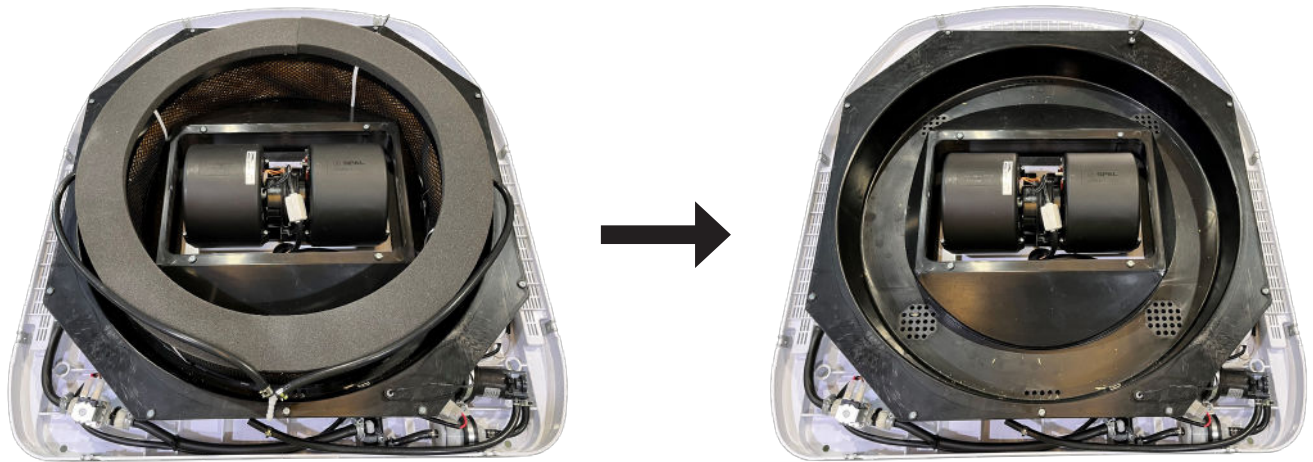

5 Scollegare i cablaggi elettrici dai sensori di livello del serbatoio dell'acqua.

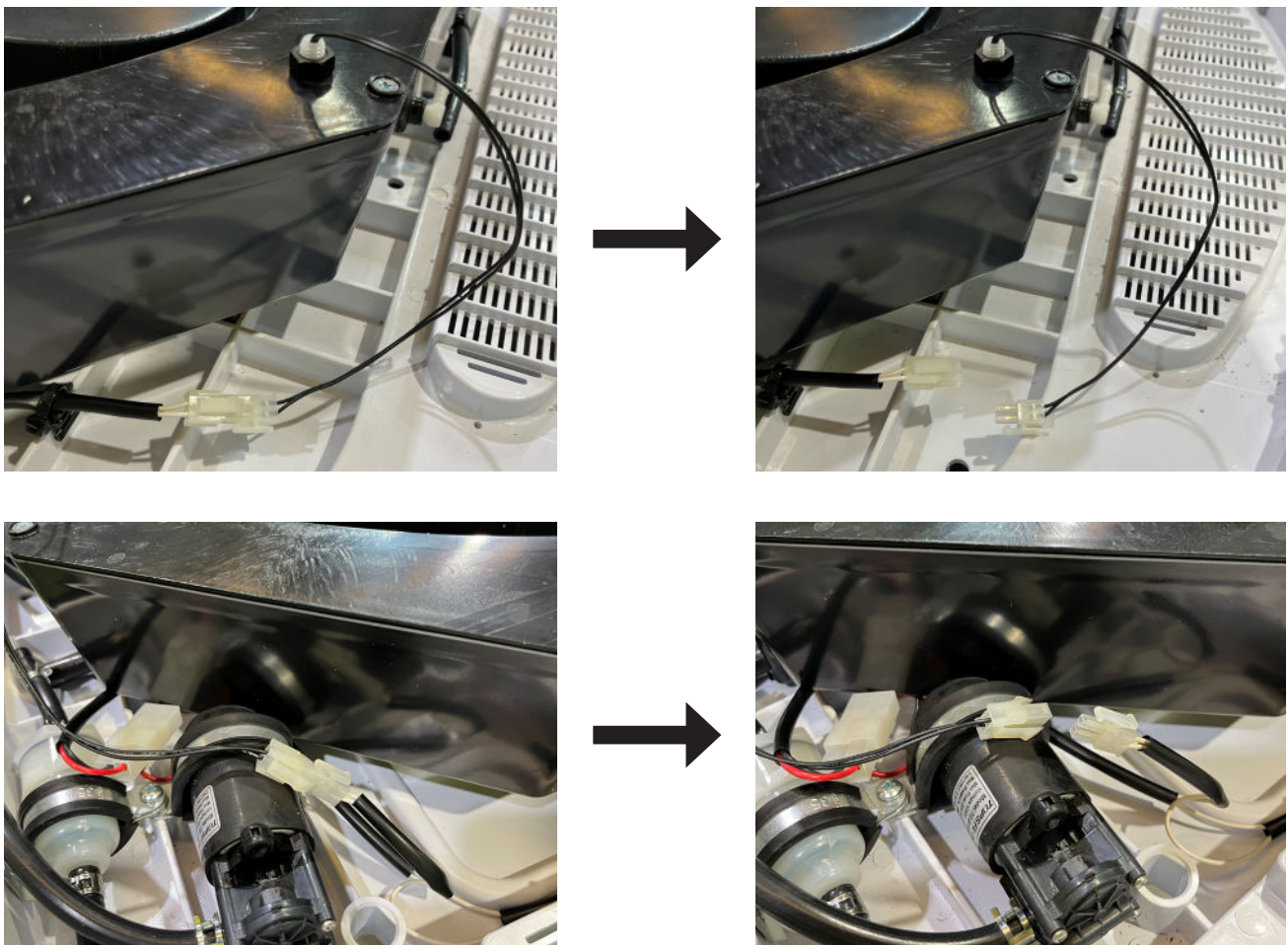

6 Smontare i tubi dell'acqua dal serbatoio.

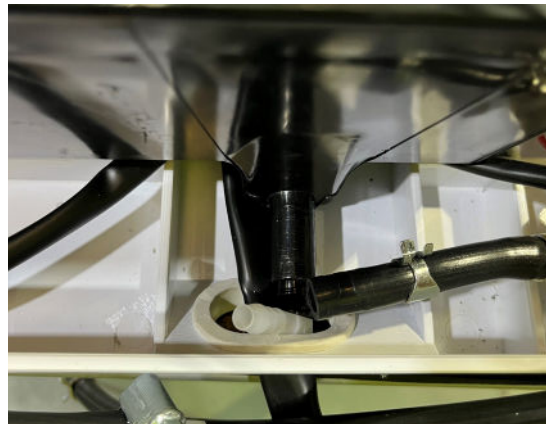
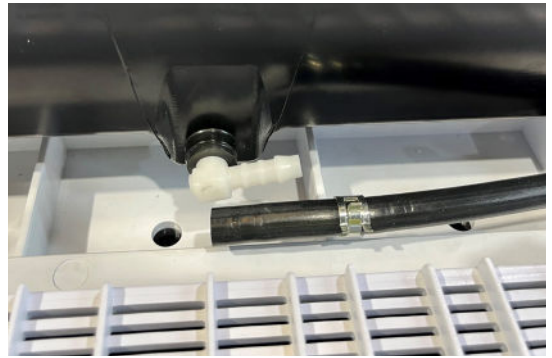
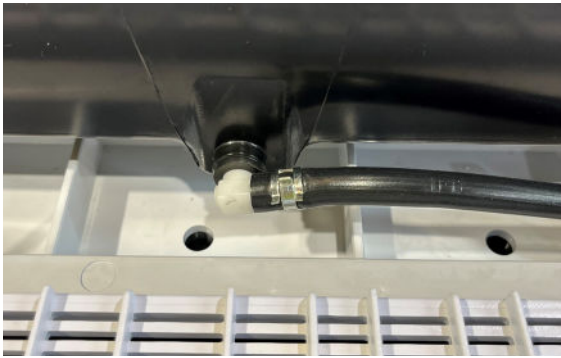

7 Togliere il serbatoio dell'acqua dal raffreddatore facendo attenzione a non versare acqua sulla base dell'unità.



8 Collocare il serbatoio di ricambio sulla base del raffreddatore inserendo i tubi di troppopieno del serbatoio nei relativi fori della base.



9 Montare i tubi dell'acqua nel serbatoio, assicurandosi che questi siano fissati correttamente.

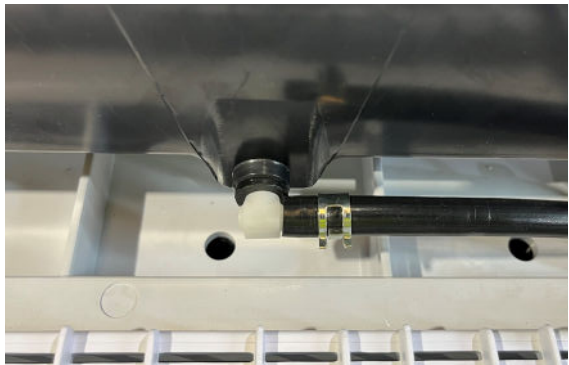

10 Montare di nuovo il filtro dell'umidità.



11

Collegare il tubo dell'acqua del filtro dell'umidità.

**12**

Collegare il cablaggio del sensore di livello posteriore del serbatoio al cablaggio di alimentazione corto (fornito nel ricambio) e questo al cablaggio di alimentazione componenti del raffreddatore.

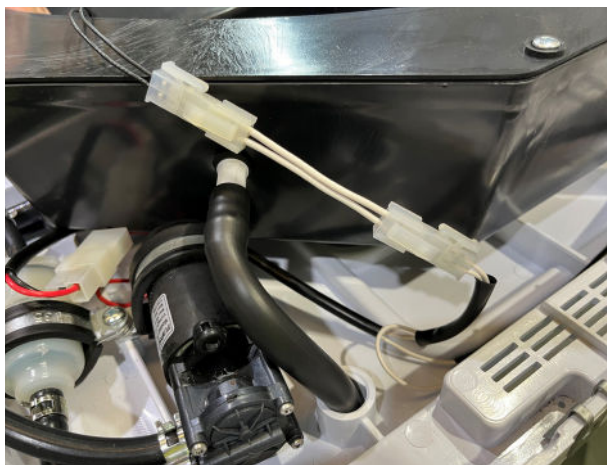
**13**

Collegare il cablaggio del sensore di livello anteriore del serbatoio al cablaggio di alimentazione lungo (fornito nel ricambio) e questo al cablaggio di alimentazione dei componenti del raffreddatore.

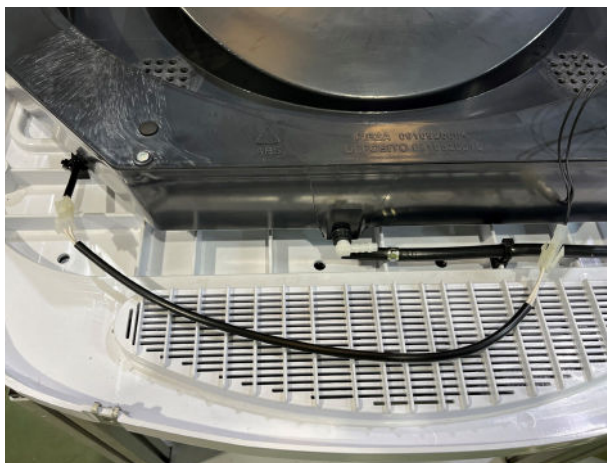

14 Montare il coperchio esterno del raffreddatore con le (8) viti di fissaggio.



15 Collegare il cavo di alimentazione del raffreddatore al cablaggio della batteria.

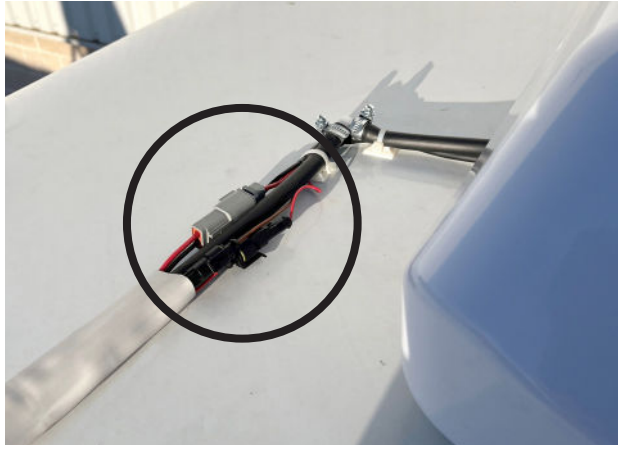

Elenco pezzi di ricambio



Id.	Qtà.	Riferimento	Descrizione
1	1	1003651563	Insieme serbatoio
2	1	1003797276	Cablaggio estensione sensore di livello



TU ESPACIO DE VIDA CONFORTABLE

Madrid, España

T. + 34 - 918-775-840

E. ventas@dirna.bergstrominc.com

W. www.bergstromspain.com

